

KING STREET, W6

£375,000

Leasehold



1



1



1



B

PROPERTY FEATURES

- Central Location
- Large Living Space
- Close To Amenities
- Chain Free
- Second Floor
- Close To Transport



PROPERTY FEATURES

A perfect first home, this property has an impressive layout that lends itself to have a large open plan living and entertaining space complete with a fully integrated kitchen. The bedroom provides a serene retreat, while the modern bathroom ensures a high quality standard of living throughout. This property is chain free.

ALEXANDER STEER
Estate Agents



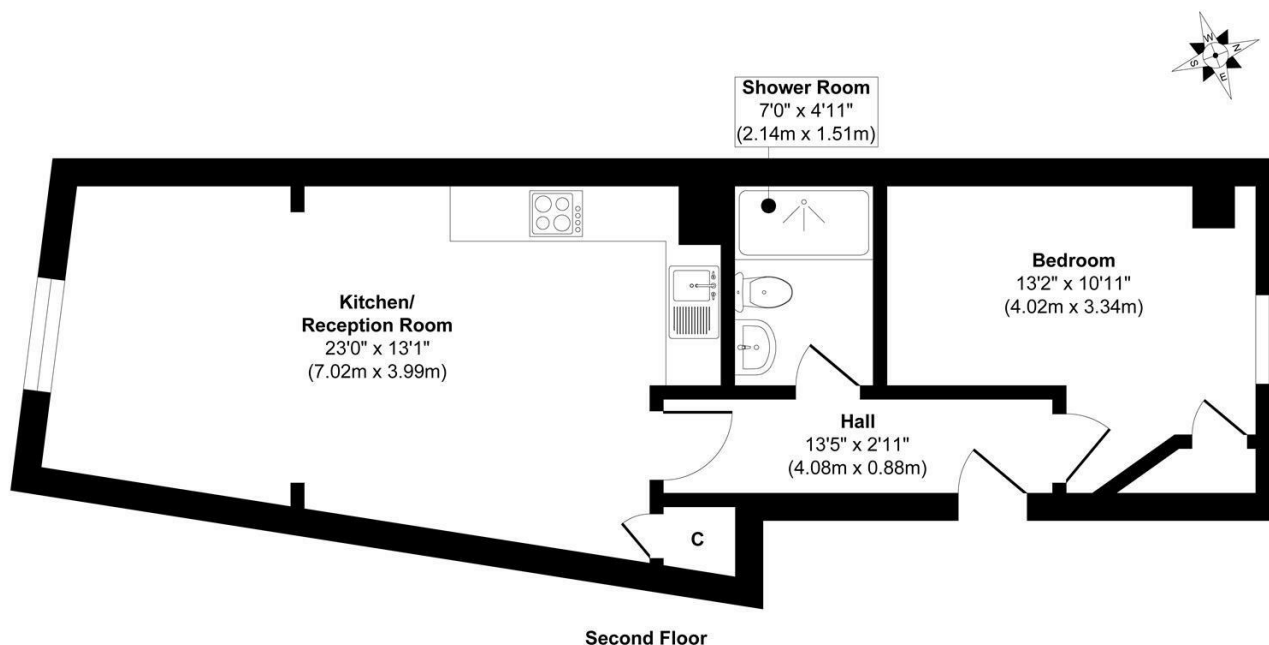

Approx. Gross Internal Floor Area 495 sq. ft / 46.00 sq. m

Illustration for identification purposes only, measurements are approximate, not to scale.

Produced by Elements Property



©ALEXANDERSTEERPROPERTY



All sizes are approximate. The Agent has not tested any apparatus, equipment, fixtures and fittings, or services and so cannot verify that they are in working order or fit for the purpose. A buyer is advised to obtain verification from their Solicitors or Surveyor. Photographs are for illustration purposes only and may depict items, which are not for sale or included in the sale price. References to tenure of a property are based upon Information supplied by the vendor. The agent has not had sight of the title documents, a buyer is advised to obtain verification from their solicitor.

Money Laundering Regulations 2003: Intending purchasers will be asked to produce identification, documentation at a later stage and we would ask for your co-operation in order that there will be no delay in agreeing the sale. These particulars are intended to give a fair description of the property only and are in no way guaranteed, nor do of any contract. They are issued on the express condition that all negotiations are conducted through Alexander Steer Estate Agents. All subject to contract and to being unsold.

**ALEXANDER
STEER**

0203 822 0111

hello@alexandersteer.co.uk

184 Brook Green Shepherds Bush Road,
Hammersmith, London, W6 7NL